

Proven Tough

Weiland doors are tough. Period. Our doors feature only heavy-duty parts and top-grade materials; and are built by expert craftsmen – many of whom have been with us since the early days. What you can expect from us is a door that has been proven to withstand the harshest conditions in the food processing industry and other industrial environments.

Heavy Duty Hardware

Weiland doesn't skimp on hardware. Our double acting doors feature heavy-duty V-Cam hinges, nylon inserted neoprene gasket, optional stainless steel push plates, optional stainless steel kick plates and optional high impact spring bumpers.

Easy Installation

Doors are completely assembled with the hardware installed, packed securely in individual wooden crates, and sent using quality freight carriers. Double acting doors install quickly.

Flexible Frame Options

Multiple frame options exist for double acting doors. One-part 16-gauge stainless steel frames install easily into concrete/masonry walls as well as metal wrapped insulated metal panel wall openings. Two-part stainless steel clad frames are available for insulated metal panel openings as well. And, Weiland can provide varying jamb depths – providing architectural flexibility.

Unmatched Service

The top priority at Weiland is YOU. You can rest assured that your doors will be built correctly, delivered on time, and your questions answered immediately. Weiland stands behind our doors with a 1-year warranty, and more importantly, with a level of personal service that's unmatched in the industry. There's a reason many of our valued customers have been with us for over 20 years.



Double Acting Door

(Shown with S/S push plates, S/S kick plates, and 12x18" vision panel.)



Double Acting Double Door

(Shown with 36" projection bumpers, push plates and 12x18" vision panels.)

There are many companies that manufacture traffic doors – but none of them build their doors tougher than Weiland. From the completely seamless 1-7/8" thick molded fiberglass door panel, to the heavy duty v-cam hinges, to the nylon-inserted neoprene gaskets, to the 16-ga stainless steel frame – Weiland double acting doors are built to withstand fork truck traffic in the most demanding food processing and cold storage environments.

402-454-2106

www.weilanddoors.com

Double Acting Door

Data Sheet

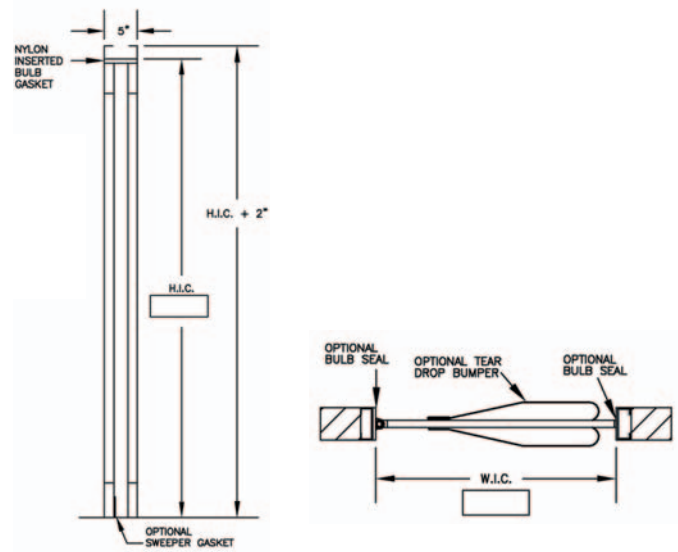
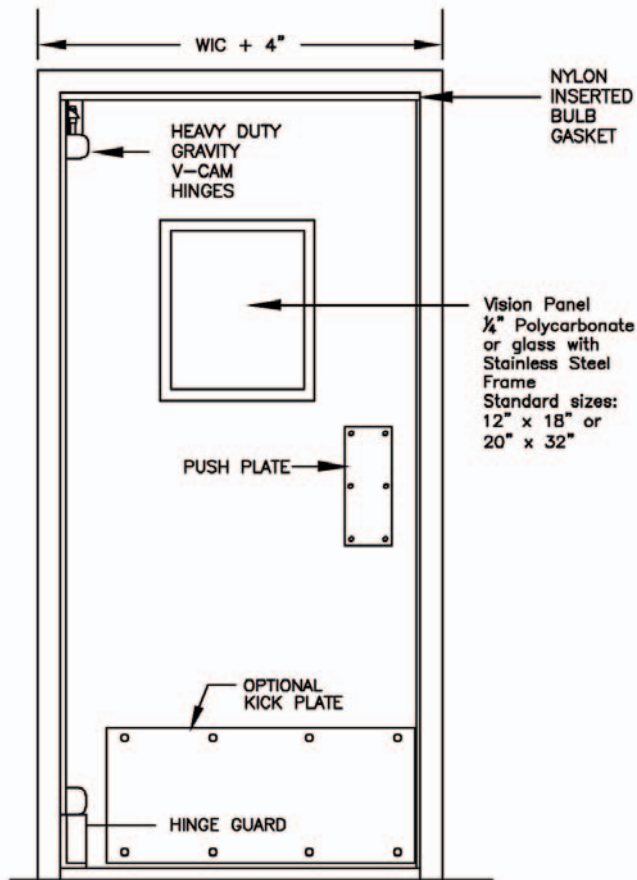

Design & Construction

Door Size

All doors are custom built for any sized opening, and are available in both single and double panel.

Door Panel Exterior

1-7/8" molded fiberglass.

Door Panel Interior

- **Frame** – Doors are built using either kiln-dried douglas fir wood, composite lumber, or high density polyethylene – depending on customer requirements.
- **Insulation** – The door panels are unitized and filled with foam-in-place polyurethane, with an "R" factor of R15.

Frame Options

- One-part 16-gauge stainless steel frames are available in any jamb depth – and are used typically in concrete masonry unit walls or metal-wrapped openings.
- Two-part metal clad frames are available in any jamb depth – and are typically used in insulated metal panel walls.
- One-part 1/4" flat bar structural frame is available as well to weld into door opening.

Gasketing

Full perimeter seal gasketing with nylon inserted neoprene

Hinges

Two (2) heavy-duty V-Cam hinges are standard on all doors (stainless steel V-Cam, ductile iron upper and lower hinge posts and heavy-duty roller assembly).

Other Options

- **Push Plates** – Stainless steel push plates for both sides of door
- **Bumpers** – Plastic spring bumpers available up to 42" high (available in 3" and 4" profiles)
- **Kickplate** – 16-gauge stainless steel kickplates up to 42" high are available on one or both sides of the door.
- **Vision Panel** – Vision panels with stainless steel frames are available for all doors. 12x18" and 20x32" sizes are standard, and custom sizes can be special ordered. Multiple glazing options exist including scratch resistant polycarbonate (Lexan), insulated glass, heated insulated glass, and polycoated insulated glass (7-mil plastic coating).

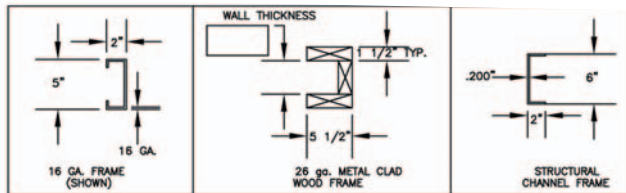

Weiland Fiberglass Doors



There is a major difference between fiberglass doors. Some manufacturers make their fiberglass doors by bonding together two shells and gel-coating to fill the seams. Other companies simply glue together panel surfaces and edges. These approaches may yield a nice looking door at first, but can leave the door susceptible to separating and delaminating when placed in abusive environments.

Weiland fiberglass doors on the other hand, are manufactured differently and are impervious to so much of the abuse in food processing and cold storage environments. Here's how we do it: We apply one continuous layer of fiberglass around all sides and edges of the door. This painstaking process uses alternating layers of resins, chopped strand fiberglass mat, and bi-directional woven fiberglass cloth to create one cohesive layer that completely surrounds the door. The result is a beautiful door with no seams to bond together, and nothing to potentially delaminate over time. A high-gloss gel-coat finish is applied to the door to provide a lasting finish that will never need painting and will withstand the harshest of abusive and caustic environments.

Weiland

55242 HWY 32 • Madison, Nebraska 68748
 Phone: 402-454-2106 • Fax: 402-454-6508
www.weilanddoors.com